

alexanders

Residential



Llanbadarn Fawr

Ceredigion

£575 pcm



1



1



1

Property Features

- Excellent condition
- 1 bedroomed 'quad'
- Furnished
- Garden
- Allocated parking
- Less than 1 mile from Aber

A modern one bedroomed house on the ever popular development of Cae Ceredig, less than a mile from the centre of Aberystwyth town centre and adjacent to the new Welsh Assembly building. The property boasts a contemporary finish with halogen down lighters, timber floors, glass balustrades and is furnished to a high standard. Ideally suiting a young professional / couple. Private, allocated parking. Full referencing will be required. EER 83



Local Authority

Ceredigion County Council

Council Tax Band

B

Energy Efficiency Rating

TBC

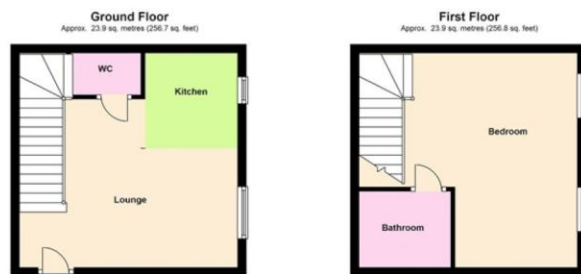

Directions

Viewing Arrangements

Strictly by appointment through Alexanders

- Administrative charges apply. Pricing listed is for monthly rental. Deposit will be required along with referencing. Individual fees vary depending on status. Full details of fees available at www.alexanders-online.co.uk/lettings/pricing and in office.

Energy Efficiency Rating		Current	Potential
Very energy efficient - lower running costs			
(92-100) A			
(81-91) B			
(69-80) C			
(55-68) D			
(39-54) E			
(21-38) F			
(1-20) G			
Not energy efficient - higher running costs			
England & Wales		EU Directive 2002/91/EC	

Environmental (CO ₂) Impact Rating		Current	Potential
Very environmentally friendly - lower CO ₂ emissions			
(92-100) A			
(81-91) B			
(69-80) C			
(55-68) D			
(39-54) E			
(21-38) F			
(1-20) G			
Not environmentally friendly - higher CO ₂ emissions			
England & Wales		EU Directive 2002/91/EC	

Alexanders Residential Lettings

Cambrian Chambers

Terrace Road

Aberystwyth

Ceredigion

SY23 1NY

Contact Us

www.alexanders-online.co.uklettings@alexanders-online.co.uk

01970 636010

Opening Hours

Monday - Friday: 9am - 6pm

Saturday: 9am - 6.30pm

Sunday: 11am - 4pm

All Please Note: Whilst every care has been taken to prepare these lettings particulars accurately, they are for guidance purposes only. Not be exclusively relied upon. These particulars do not constitute any part of a contract and they should measurements are approximate and plans included for illustrative purposes.